



## Accurate Real-time Location Tracking

Powered by NEC IP DECT and Ekahau RTLS

### *At a Glance*

- Combine IP DECT with Ekahau for staff and patient safety scenarios
- Location accuracy within critical parameter (< 5 meter)
- Full two-way alerting and communication capabilities
- Complete escalation and reporting capabilities through Ekahau user-friendly GUI (Ekahau Vision)
- Certified interworking through DMLS interface (standard open NEC IP DECT protocol)
- Further enhancement with Messaging systems through DMLS and Ekahau XML interface (i.e. Mobicall from New Voice, iXarma etc.)
- Can be combined with Ekahau WLAN asset tracking

Ekahau RTLS is an accurate and efficient way to locate people and assets in order to improve business operations, save money and improve efficiency.

Ekahau location tracking technology can now easily be combined with NEC's IP DECT wireless communications systems, allowing organizations to accurately locate and track those handsets that are in the coverage area of an NEC IP DECT infrastructure. The powerful combination of Ekahau and NEC's IP DECT can thus facilitate various staff- and patient safety scenarios.

### *Benefits*

Many large organizations have IP DECT deployments, where staff use DECT handsets and where IP DECT is recognized for its quality and reliability in mission-critical environments. This applies particularly to Healthcare and Hospitality environments as well as to a variety of industrial sectors. The combination of IP DECT with Ekahau RTLS brings many benefits:

- Ensures staff safety
- Finds and tracks staff and patients

Thanks to the very accurate location determination of DECT handsets, staff assistance can be directed right to the required spot. The same applies to patients with a need for immediate care.

The location solution for DECT handsets can easily be combined with other Ekahau location technologies based on WLAN, as well as on other RFID mechanisms. As Ekahau is the global leader in RTLS, customers are guaranteed a fast ROI and end-users (e.g. hospital staff) can be assured of working in an environment where their safety is guarded.

*Solution example: Staff safety*

Ensuring the safety of staff members in a hectic and highly mobile environment is a challenge to many organizations in Healthcare, in prisons and many other sensitive environments. Carers, guards and other staff can be exposed to risky situations or may require immediate assistance. The combination of IP DECT and Ekahau RTLS

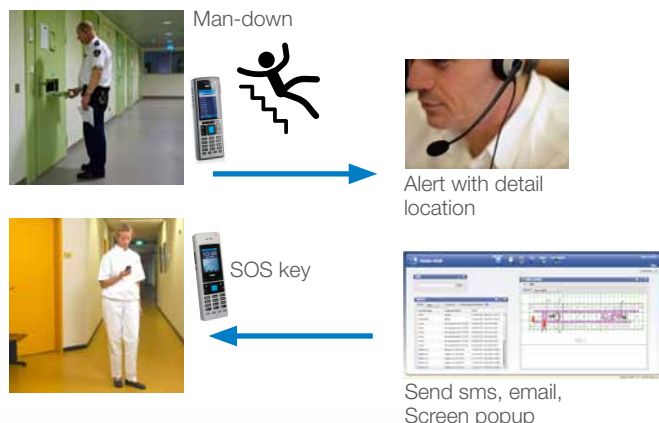

ensures that when the handset or Messenger SOS button is used, or when the handset shows a man-down indication, a central alert is given including escalation by means of a variety of media, such as sms, email or by voice conversation. This is facilitated by Ekahau Vision and can be further enhanced with a dedicated messaging system to escalate to other staff members using their DECT handset messaging.

*Solution example: find and trace people*

To find people and to ensure that they stay within a certain area can be a challenge within Healthcare institutions where patients are ambulant and may roam away unattended.

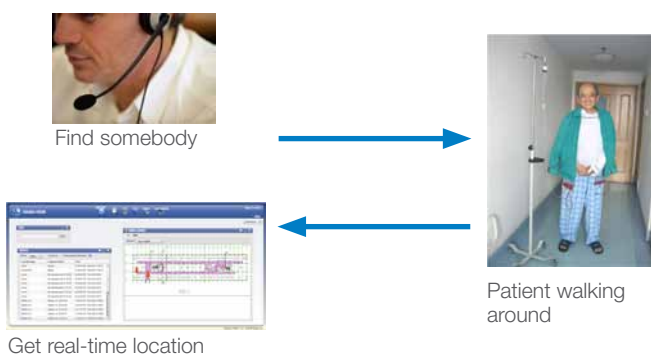

Also in other segments it can be instrumental to trace staff, such as in prisons. With Vision, the actual position of individuals wearing a DECT handset or Messenger device can be shown in real-time. The system also allows for dedicated settings to assure that people stay within a certain area.



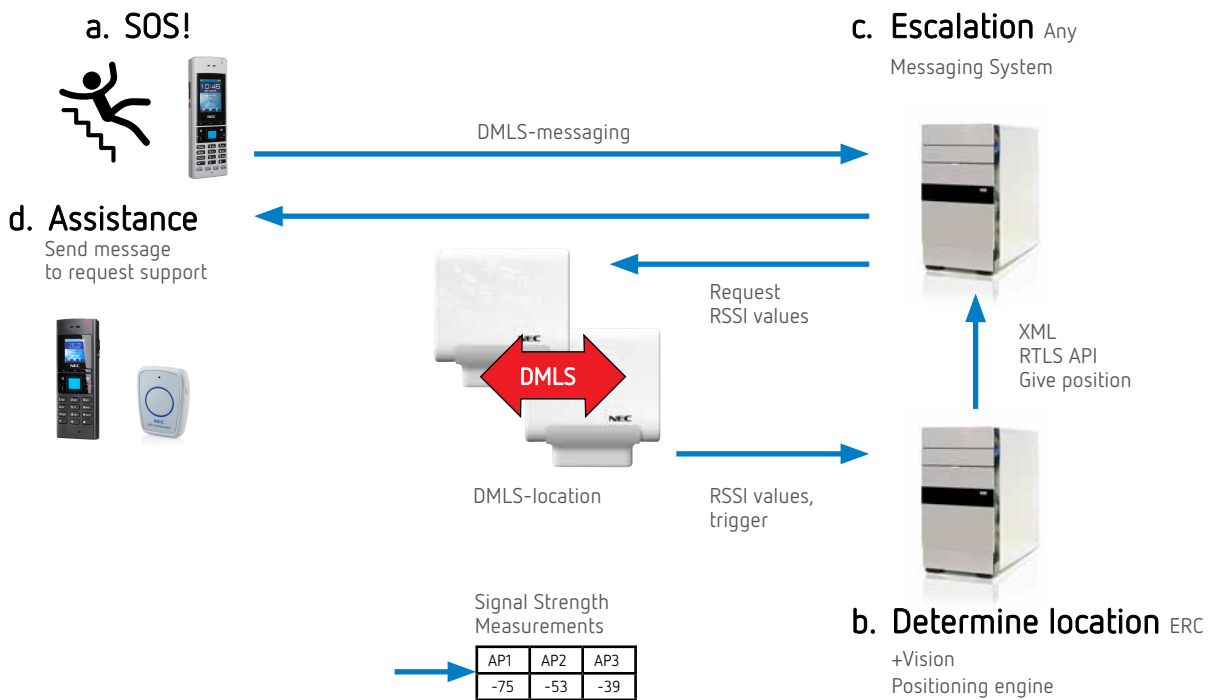

### NEC RTLS Elements

The fully integrated NEC location solution consists of the following elements:

- IP DECT, based on either APx00 series Access Points running R5.0 (or later) software. Capacity – up to 2000 APs. The system must include the DMLS open interface.
- IP DECT Handsets I766, G566 or Communicator M166
- Ekahau RTLS Controller with the Ekahau Positioning Engine V 4.6 (or later)
- Ekahau Vision, a web application to immediately locate people and assets from virtually any computer. It also provides an XML interface to an additional messaging application
- Ekahau ESS, a site survey tool that has been adapted to work with the NEC IP DECT and I766 handset
- Optional Messaging system to complement the Vision escalation scenarios or to extend Vision to DECT handset messaging to and from the handsets

### NEC's vision on Healthcare Communication

Based on our vast experience in the Healthcare sector, we have a clear vision on how to balance the needs and core-focus of any Healthcare (patient-care) institution with the stringent requirements of today's financial regime. Our cost-effective solutions ensure efficient operations and enable institutions to provide the best possible care to an aging population that considers health as the most essential component of personal well-being.

NEC is a leading provider of Healthcare communications to institutions of all types and sizes worldwide. Our proven solutions are based on innovative technology and are frequently developed in close collaboration with leading complementary solution providers.

The Healthcare communications solutions of NEC empower institutions, their staff and their patients by placing individuals at the centre of C3 – Communications for Care and Cure.

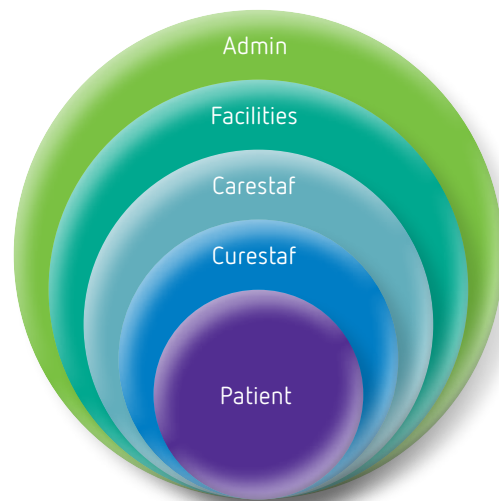

Communications for Care and Cure

UNIVERGE®360 is NEC's approach to unifying business communications. It places people at the center of communications and delivers on an organization's needs by uniting infrastructure, communications and business.



**About NEC Corporation:** NEC Corporation is one of the world's leading providers of Internet, broadband network and enterprise business solutions dedicated to meeting the specialized needs of its diverse and global base of customers. NEC delivers tailored solutions in the key fields of computer, networking and electron devices, by integrating its technical strengths in IT and Networks, and by providing advanced semiconductor solutions through NEC Electronics Corporation. The NEC Group employs more than 150,000 people worldwide. For additional information, please visit the NEC home page at: <http://www.nec.com>

For further information please contact your local NEC representative or:

**EMEA (Europe, Middle East, Africa)**  
NEC Enterprise Solutions  
[www.nec-enterprise.com](http://www.nec-enterprise.com)

**North America (USA)**  
NEC Corporation of America  
[www.necam.com](http://www.necam.com)

**Corporate Headquarters (Japan)**  
NEC Corporation  
[www.nec.com](http://www.nec.com)

Empowered by Innovation

